

Lined Tote. Size is flexible but give ½ inch or 1.2cm seam allowances. Generally, work around a finished size of approx. 43cm or 17”sq – give or take a few inches! Easier to do in batches.

Cut out

- 1) **1 x Outer Piece** in medium to heavy weight fabric – 9cm or 4 “higher and 2cm or 1” wider than finished bag size. **Eg 88cm x 52cm or 35”x 21”**
- 2) **1 x Lining** in medium to light fabric – 15cm or 6” shorter than piece 1) but same width. **Eg 88cm x 37cm or 35”x 15”**
- 3) **Straps** in medium to heavy weight fabric – NB – best make long lengths of strap and cut to length as needed. **7cm or 2½” wide.** A **40cm / 16”** length will do 1 handle, make longer for over the shoulder if you wish

A) Fold and press straps lengthwise as shown then stitch along long fold in middle trapping rough edge under

B) Adjusting for seam allowances divide top long edge of outer piece into 4. A “no -measure” way involves folding fabric in half, then fold back again but with outside edges over sailing the first fold edge by ½” or 1.2cm(seam allowance). Tricky to visualise but a real time saver once done!

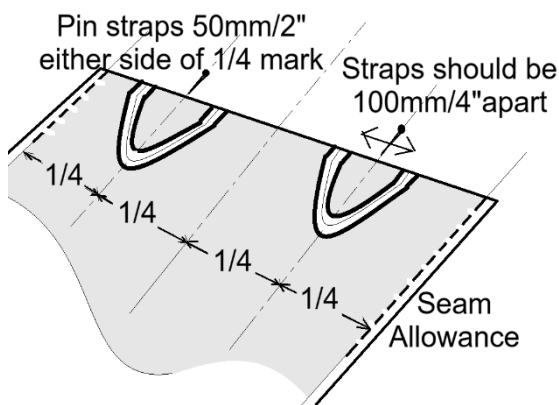
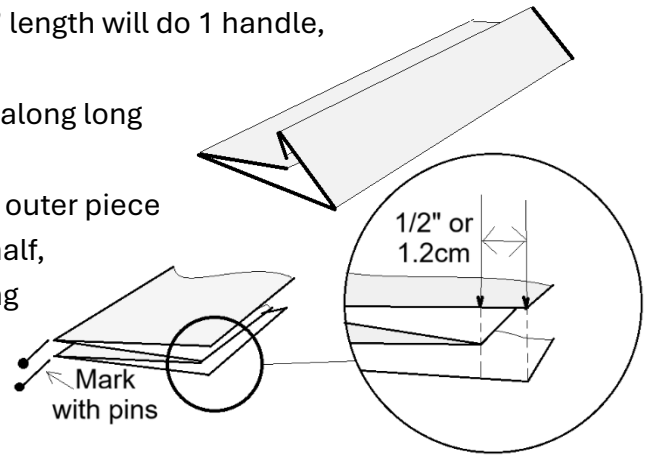

C) Pin the straps smooth side to right side of outer fabric as shown about 2” or 50mm either side of centres marked with pins.

D) Right side to right side, pin lining to outer, sandwiching straps between lining and outer and sew along strap edge.

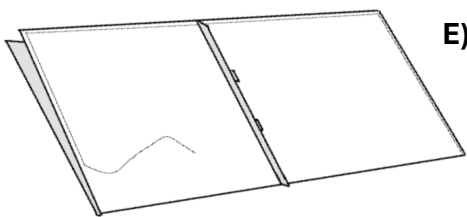
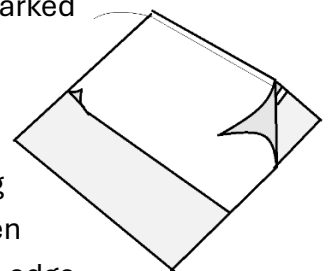

E) Open out then press all seams towards outer fabric.

F) Fold as shown, sew all round leaving a 100mm/4” gap in lining

G) Turn right side out through hole in lining, sew up gap in lining and push lining into bag.

H) Even up the internal ‘cuff’ and press round top edge – pin straps into place, sew all round 5mm / ¼” over the lining/outer shell seam.

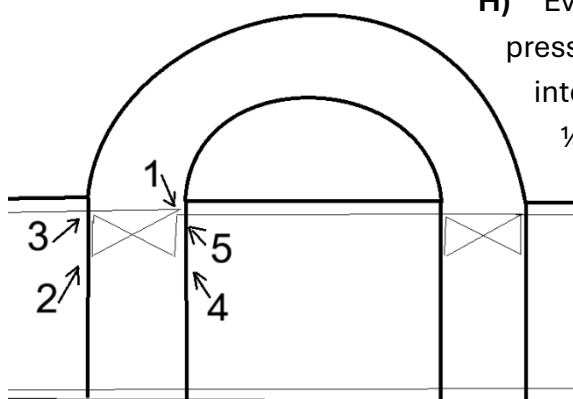

I) Sew around top edge, 5mm/¼” in from top edge using diagonal reinforcement over the straps as shown,

